

# DFS型干燥过滤器 Model DFS Dry Filter

## 产品概述 Product Description

- DFS型干燥过滤器用于制冷空调装置的液体管路上, 用来干燥制冷剂(吸收系统的水分)及过滤系统内的固体杂质, 以有效而安全地保护制冷空调系统。
- DFS型干燥过滤器的主要组分是100%3A分子筛和100um滤棉。
- DFS型干燥过滤器的分子筛是100%3A固体滤芯, 可用于HCFC和HCFC制冷剂以及合成聚脂油 (POE或PAG) 系统。

- Model DFS dry filter is used on the liquid piping of refrigeration and air conditioning unit to dry refrigerant (absorb water from system) and filter the solid from system in order to protect the refrigeration and air conditioning system for an efficient and safety operation.
- Model DFS dry filter is composed of 100% 3A molecular sieve and 100um filter cartridge.
- Model DFS dry filter's molecular sieve is 100% 3A solid filter cartridge. This solid filter is used for HFC and HCFC refrigerants and synthesized polyester oil (POE or PAG) system.

## 产品特点 Features

- 100%3A固体滤芯, 干燥能力强, 不会相互移动, 避免了粉末的产生。
- 40um过滤精度, 可在最小压降下保持高效过滤, 耐腐蚀的表面粉末喷涂, 可用于各种环境标准接口及焊口连接, 也可按用户需要定制可任意方向安装。

- 100% 3A filter cartridge with powerful drying capacity, not mutual mobile, avoid the powder production.
- With a filter fineness of 40  $\mu$ m. Corrosion resistant powder coating finish is applicable to various environments. Threaded connection and welded connection is normal design and customer design is available. Could be mounted in any desirable direction.

## 外形结构 Configuration

### 螺口 Thread:

- 1.橡胶塞帽 rubber plug
- 2.螺纹封帽 thread cap
- 3.铁接头 steel connector
- 4.铁碗 steel cup
- 5.挡片 barrier
- 6.烧结滤芯 solid filter cartridge
- 7.滤棉 filter pad
- 8.滤网 filter net
- 9.标签 label

### 焊口 Soldering:

- 1.橡胶塞帽 rubber plug hat
- 2.接管焊接 pipe
- 3.铁碗 steel cup
- 4.挡片 barrier
- 5.烧结滤芯 solid filter cartridge
- 6.滤棉 filter pad
- 7.滤网 filter net
- 8.标签 label

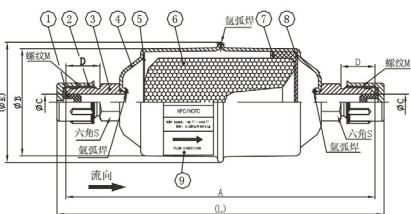

螺口 Thread



## 技术参数 Technical Parameters

|                                       |                |
|---------------------------------------|----------------|
| 适用制冷剂 Applicable Refrigerant:         | HCFC、HFC       |
| 适用介质温度 Applicable Medium Temperature: | -40°C ~ +120°C |
| 最大工作压力 Maxmum Working Pressure        | 4.2MPa         |
| 最大试验压力 Maximum Test Pressure          | 6.3MPa         |

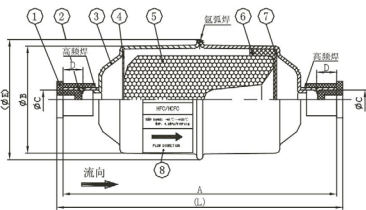

焊口 Soldering

## 选型 Product Model

| 螺口 Thread |          | 焊口 Soldering |          |      |          |
|-----------|----------|--------------|----------|------|----------|
| 型号 Model  |          | 型号 Model     |          |      | 规格 Size  |
| DFS-052   | ----     | ----         | ----     | ---- | 1/4ODF   |
| DFS-053S  | DFS-083S | DFS-163S     | ----     | ---- | 3/8ODF   |
| ----      | DFS-084S | DFS-164S     | DFS-304S | ---- | 1/2ODF   |
| ----      | DFS-085S | DFS-165S     | DFS-305S | ---- | 5/8ODF   |
| ----      | ----     | ----         | DFS-306S | ---- | 3/4ODF   |
| ----      | ----     | ----         | DFS-307S | ---- | 7/8ODF   |
| ----      | ----     | ----         | DFS-309S | ---- | 1-1/8ODF |

## SAE 接口 SAE connection

| 型号 Model | 接口 Connection | A   | φB    | φC   | D    | φE    | L   | S  | 螺纹 Thread M  | 重量 Weight(g) |
|----------|---------------|-----|-------|------|------|-------|-----|----|--------------|--------------|
| DFS-032  | 1/4SAE        | 109 | 43    | φ4.8 | 14   | φ48.5 | 113 | 14 | 7/16-20UNF   | 183          |
| DFS-033  | 3/8SAE        | 118 | 43    | φ8   | 17   | φ48.5 | 127 | 16 | 5/8-18UNF    | 211          |
| DFS-052  | 1/4SAE        | 119 | φ53.5 | φ4.8 | 14   | φ60.5 | 125 | 14 | 7/16-20UNF   | 261          |
| DFS-053  | 3/8SAE        | 128 | φ53.5 | φ8   | 17   | φ60.5 | 137 | 16 | 5/8-18UNF    | 289          |
| DFS-083  | 3/8SAE        | 154 | φ53.3 | φ8   | 17   | φ60.5 | 163 | 16 | 5/8-18UNF    | 372          |
| DFS-084  | 1/2SAE        | 162 | φ53.3 | φ10  | 19   | φ60.5 | 172 | 19 | 3/4-16UNF    | 403          |
| DFS-085  | 5/8SAE        | 173 | φ53.3 | φ13  | 23.5 | φ60.5 | 185 | 22 | 7/8-14UNF    | 440          |
| DFS-163  | 3/8SAE        | 160 | φ75   | φ8   | 17   | φ84.5 | 169 | 16 | 5/8-18UNF    | 615          |
| DFS-164  | 1/2SAE        | 168 | φ75   | φ10  | 19   | φ84.5 | 178 | 19 | 3/4-16UNF    | 655          |
| DFS-165  | 5/8SAE        | 179 | φ75   | φ13  | 23.5 | φ84.5 | 191 | 22 | 7/8-14UNF    | 695          |
| DFS-304  | 1/2SAE        | 262 | φ79   | φ10  | 19   | φ79   | 272 | 19 | 3/4-16UNF    | 1325         |
| DFS-305  | 5/8SAE        | 272 | φ79   | φ13  | 21   | φ79   | 284 | 22 | 7/8-14UNF    | 1365         |
| DFS-306  | 3/4SAE        | 273 | φ79   | φ16  | 25   | φ79   | 285 | 27 | 1-1/16-14UNF | 1423         |

## ODF 接口 ODF connection

| 型号 Model | 接口 Connection | A   | φB    | φC    | D    | φE    | L   | 重量 Weight (g) |
|----------|---------------|-----|-------|-------|------|-------|-----|---------------|
| DFS-032S | 1/4ODF        | 99  | φ43   | φ6.5  | 8    | φ48.5 | 103 | 159           |
| DFS-033S | 3/8ODF        | 101 | φ43   | φ9.6  | 10   | φ48.5 | 107 | 166           |
| DFS-052S | 1/4ODF        | 109 | φ53.5 | φ6.5  | 8    | φ60.5 | 113 | 235           |
| DFS-053S | 3/8ODF        | 111 | φ53.5 | φ9.6  | 10   | φ60.5 | 117 | 242           |
| DFS-083S | 3/8ODF        | 137 | φ53.5 | φ9.6  | 10   | φ60.5 | 143 | 320           |
| DFS-084S | 1/2ODF        | 145 | φ53.5 | φ12.9 | 11   | φ60.5 | 151 | 335           |
| DFS-085S | 5/8ODF        | 145 | φ53.5 | φ16   | 11   | φ60.5 | 151 | 348           |
| DFS-163S | 3/8ODF        | 143 | φ75   | φ9.6  | 10   | φ84.5 | 149 | 527           |
| DFS-164S | 1/2ODF        | 151 | φ75   | φ12.9 | 11   | φ84.5 | 157 | 542           |
| DFS-165S | 5/8ODF        | 151 | φ75   | φ16   | 11   | φ84.5 | 157 | 547           |
| DFS-304S | 1/2ODF        | 245 | φ79   | φ12.9 | 11   | φ79   | 251 | 1263          |
| DFS-305S | 5/8ODF        | 245 | φ79   | φ16   | 11   | φ79   | 251 | 1268          |
| DFS-306S | 3/4ODF        | 250 | φ79   | φ19.2 | 12   | φ79   | 256 | 1286          |
| DFS-307S | 7/8ODF        | 256 | φ79   | φ22.4 | 12.5 | φ79   | 262 | 1302          |

# DFS型干燥过滤筒

## Model DFS Replaceable Dry Filter Cartridge



### 产品概述 Product Description

- DFS型干燥过滤筒安装在系统的液、汽管路中，可有效去除残留的污染物，从而使压缩机得到更好的保护，延长其使用寿命。
- DFS型干燥过滤筒是可更换滤芯的，最大的特点是用于吸附压缩机马达烧毁后进入系统中大量的水分

- Model DFS dry filter cartridge is installed on the liquid and vapor piping, which could effectively remove any residual contaminant to protect compressor for a longer service life.
- The filter element of Model DFS dry filter cartridge is replaceable and it is capable to absorb large amount of water in the system in case the compressor motor burns up.

### 产品特点 Features

- 可拆式结构、便于安装及维修；
- 100目出口滤网；
- 全流通设计，最大限度的减少压降；
- 钢制壳体，铜接管焊接接口，高频焊接采用翻边结构，增加焊接可靠性；
- 改性聚四氟乙烯新型材料，确保密封性；
- 外涂层采用环氧树脂静电喷涂。

- Removable structure for convenient installation and maintenance;
- 100 mesh outlet filter screen;
- Full pass through design to minimize pressure drop;
- Steel casing, copper pipe welded connection, high frequency welding flanging structure to improve welding reliability;
- Modified Teflon new material to ensure perfect sealing;
- Outer surface applies epoxy resin coating protection.

### 技术参数 Technical Parameters

|                                    |              |
|------------------------------------|--------------|
| 适用制冷剂 Suitable Refrigerants        | HCFC、HFC、CFC |
| 适用介质温度 Suitable Medium Temperature | -35℃~+70℃    |
| 最大工作压力 Maximum Working Pressure    | 4.2MPa       |
| 最大试验压力 Maximum Test Pressure       | 6.3MPa       |

| 型号<br>Type | 进出口尺寸<br>Connections To<br>solder ID Finch | 芯体数量<br>Number of cores | 过滤面积(m <sup>2</sup> )<br>Filtering surface(m <sup>2</sup> ) | 尺寸 Dimensions (mm) |     |     |
|------------|--|-------------------------|---|--------------------|-----|-----|
|            |  |                         |   | A                  | B   | C   |
| DFS-485S   | 5/8ODF                                     | 1                       | 420   | 234                | 153 | 85  |
| DFS-486S   | 3/4ODF                                     |                         |   | 234                | 153 | 85  |
| DFS-487S   | 7/8ODF                                     |                         |   | 234                | 153 | 85  |
| DFS-489S   | 1-1/8ODF                                   |                         |   | 236                | 155 | 87  |
| DFS-4811S  | 1-3/8ODF                                   |                         |   | 240                | 159 | 91  |
| DFS-4813S  | 1-5/8ODF                                   |                         |   | 242                | 161 | 93  |
| DFS-4817S  | 2-1/8ODF                                   |                         |   | 246                | 160 | 99  |
| DFS-4821S  | 2-5/8ODF                                   |                         |   | 244                | 158 | 106 |
| DFS-967S   | 7/8ODF                                     |                         |   | 376                | 295 | 85  |
| DFS-969S   | 1-1/8ODF                                   |                         |   | 378                | 297 | 87  |
| DFS-9611S  | 1-3/8ODF                                   | 2                       | 840   | 382                | 301 | 91  |
| DFS-9613S  | 1-5/8ODF                                   |                         |   | 384                | 303 | 93  |
| DFS-9617S  | 2-1/8ODF                                   |                         |   | 388                | 302 | 99  |
| DFS-9621S  | 2-5/8ODF                                   |                         |   | 386                | 300 | 106 |
| DFS-1449S  | 1-1/8ODF                                   |                         |   | 520                | 439 | 87  |
| DFS-14411S | 1-3/8ODF                                   |                         |   | 524                | 443 | 91  |
| DFS-14413S | 1-5/8ODF                                   | 3                       | 1260  | 526                | 445 | 93  |
| DFS-14417S | 2-1/8ODF                                   |                         |   | 530                | 444 | 99  |
| DFS-14421S | 2-5/8ODF                                   |                         |   | 528                | 442 | 106 |
| DFS-19211S | 1-3/8ODF                                   |                         |   | 668                | 587 | 91  |
| DFS-19213S | 1-5/8ODF                                   | 4                       | 1680  | 670                | 589 | 93  |
| DFS-19217S | 2-1/8ODF                                   |                         |   | 674                | 588 | 99  |
| DFS-19221S | 2-5/8ODF                                   |                         |   | 670                | 584 | 106 |

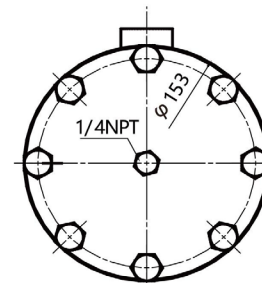
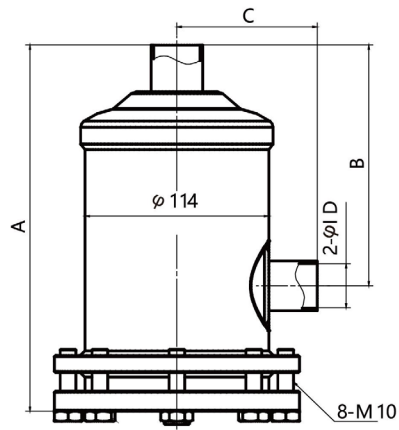

技术参数表 Technical Parameters

| 型号<br>Type |      | ARI标准状态下的额定值 Rating under Ari Standard Condition |      |                                      |      |                                 |      |  |      |                                  |       |   |           |      |           |       | 选择推荐值( Kw ) Recommended value                                     |           |       |   |  |
|------------|------|--|------|--------------------------------------|------|---------------------------------|------|--|------|----------------------------------|-------|---|-----------|------|-----------|-------|---|-----------|-------|---|--|
|            |      | 水流量——点滴数 Water volume-number of drop             |      |                                      |      |                                 |      |  |      |                                  |       | 制冷剂流过能量 refrigerant flow through energy |           |      |           |       | 制冷 refrigeration  |           |       | 空调 air conditioning                                       |  |
|            |      | 制冷剂<br>Refrigerant<br>R12 15PPM                  |      | 制冷剂<br>Refrigerant<br>R134a<br>80PPM |      | 制冷剂<br>Refrigerant<br>R22 60PPM |      | 制冷剂<br>Refrigerant<br>R404a/507<br>50PPM |      | 制冷剂<br>Refrigerant<br>R502 30PPM |       | 压差<br>pressure differential = 0.014mpa  |           |      |           |       | 商用制冷及低温设备<br>Commercial refrigeration<br>and cryo genic equipment |           |       | 现场更换现场<br>Replacementon<br>site. Site assembly<br>system. |  |
| 25°C       | 50°C | 25°C   | 50°C | 25°C                                 | 50°C | 25°C                            | 50°C | 25°C                                     | 50°C | R12                              | R134a | R22                                     | R404a/507 | R502 | R12/R134a | R22   | R404a/502507  | R12/R134a | R22   |   |  |
| DPS-4855   | 25.6 | 27.2   | 22.0 | 18.4                                 | 17.4 | 14.4                            | 20.4 | 15.5                                     | 18.2 | 14.1                             | 53.5  | 64.7                                    | 70.3      | 52.8 | 45        | 26.4  | 35.2  | 26.4      | 26.4  | 35.2  |  |
| DPS-4875   | 25.6 | 27.2   | 22.0 | 18.4                                 | 17.4 | 14.4                            | 20.4 | 15.5                                     | 18.2 | 14.1                             | 89.7  | 209                                     | 116       | 87.9 | 75.3      | 42.2  | 52.8  | 35.2      | 42.2  | 52.8  |  |
| DPS-4895   | 25.6 | 27.2   | 22.0 | 18.4                                 | 17.4 | 14.4                            | 20.4 | 15.5                                     | 18.2 | 14.1                             | 162   | 195                                     | 211       | 158  | 136       | 42.2  | 52.8  | 35.2      | 52.8  | 70.3  |  |
| DPS-48115  | 25.6 | 27.2   | 22.0 | 18.4                                 | 17.4 | 14.4                            | 20.4 | 15.5                                     | 18.2 | 14.1                             | 183   | 234                                     | 250       | 230  | 197       | 42.2  | 52.8  | 35.2      | 52.8  | 70.3  |  |
| DPS-48135  | 25.6 | 27.2   | 22.0 | 18.4                                 | 17.4 | 14.4                            | 20.4 | 15.5                                     | 18.2 | 14.1                             | 192   | 274                                     | 299       | 197  | 180       | 47.8  | 48.2  | 42.2      | 56.3  | 74.6  |  |
| DPS-48175  | 25.6 | 27.2   | 22.0 | 18.4                                 | 17.4 | 14.4                            | 20.4 | 15.5                                     | 18.2 | 14.1                             | 205   | 310                                     | 338       | 236  | 217       | 49.3  | 64.9  | 74.1      | 60.2  | 78.5  |  |
| DPS-48215  | 25.6 | 27.2   | 22.0 | 18.4                                 | 17.4 | 14.4                            | 20.4 | 15.5                                     | 18.2 | 14.1                             | 237   | 336                                     | 347       | 269  | 239       | 52.7  | 67.3  | 49.7      | 63.3  | 80.2  |  |
| DPS-9675   | 51.2 | 44.3   | 44.0 | 36.8                                 | 34.7 | 28.8                            | 40.8 | 30.9                                     | 36.3 | 28.2                             | 147   | 177                                     | 190       | 144  | 123       | 70.3  | 87.9  | 52.8      | 70.3  | 87.9  |  |
| DPS-9695   | 51.2 | 44.3   | 44.0 | 36.8                                 | 34.7 | 28.8                            | 40.8 | 30.9                                     | 36.3 | 28.2                             | 183   | 220                                     | 236       | 176  | 153       | 87.9  | 128   | 87.9      | 87.9  | 123   |  |
| DPS-96115  | 51.2 | 44.3   | 44.0 | 36.8                                 | 34.7 | 28.8                            | 40.8 | 30.9                                     | 36.3 | 28.2                             | 211   | 255                                     | 276       | 195  | 187       | 111.5 | 152   | 111.1     | 111.1 | 155   |  |
| DPS-96135  | 51.2 | 44.3   | 44.0 | 36.8                                 | 34.7 | 28.8                            | 40.8 | 30.9                                     | 36.3 | 28.2                             | 263   | 297                                     | 311       | 232  | 213       | 123.1 | 194   | 134.5     | 134.5 | 190   |  |
| DPS-96175  | 51.2 | 44.3   | 44.0 | 36.8                                 | 34.7 | 28.8                            | 40.8 | 30.9                                     | 36.3 | 28.2                             | 293   | 332                                     | 329       | 367  | 303       | 135.1 | 203   | 157       | 156   | 208   |  |
| DPS-96215  | 51.2 | 44.3   | 44.0 | 36.8                                 | 34.7 | 28.8                            | 40.8 | 30.9                                     | 36.3 | 28.2                             | 326   | 352                                     | 347       | 393  | 314       | 157   | 220   | 191       | 173   | 232   |  |
| DPS-14495  | 76.8 | 66.5   | 66.0 | 55.2                                 | 52.1 | 43.2                            | 61.2 | 46.4                                     | 54.5 | 42.3                             | 220   | 265                                     | 285       | 215  | 184       | 106   | 141   | 106       | 106   | 141   |  |
| DPS-144115 | 76.8 | 66.5   | 66.0 | 55.2                                 | 52.1 | 43.2                            | 61.2 | 46.4                                     | 54.5 | 42.3                             | 254   | 305                                     | 327       | 246  | 212       | 141   | 176   | 123       | 141   | 176   |  |
| DPS-144135 | 76.8 | 66.5   | 66.0 | 55.2                                 | 52.1 | 43.2                            | 61.2 | 46.4                                     | 54.5 | 42.3                             | 282   | 374                                     | 358       | 270  | 245       | 183   | 205   | 134       | 173   | 206   |  |
| DPS-144175 | 76.8 | 66.5   | 66.0 | 55.2                                 | 52.1 | 43.2                            | 61.2 | 46.4                                     | 54.5 | 42.3                             | 310   | 431                                     | 392       | 301  | 279       | 224   | 236   | 156       | 205   | 247   |  |
| DPS-144215 | 76.8 | 66.5   | 66.0 | 55.2                                 | 52.1 | 43.2                            | 61.2 | 46.4                                     | 54.5 | 42.3                             | 441   | 469                                     | 432       | 486  | 416       | 243   | 257   | 182       | 216   | 264   |  |
| DPS-192115 | 102  | 88.6   | 88.0 | 73.6                                 | 69.4 | 57.6                            | 81.6 | 61.8                                     | 72.6 | 56.4                             | 322   | 387                                     | 415       | 313  | 269       | 176   | 246   | 176       | 176   | 246   |  |
| DPS-192135 | 102  | 88.6   | 88.0 | 73.6                                 | 69.4 | 57.6                            | 81.6 | 61.8                                     | 72.6 | 56.4                             | 373   | 447                                     | 478       | 362  | 312       | 211   | 281   | 193       | 211   | 287   |  |
| DPS-192175 | 102  | 88.6   | 88.0 | 73.6                                 | 69.4 | 57.6                            | 81.6 | 61.8                                     | 72.6 | 56.4                             | 390   | 471                                     | 503       | 380  | 327       | 229   | 229   | 211       | 229   | 229   |  |
| DPS-192215 | 102  | 88.6   | 88.0 | 73.6                                 | 69.4 | 57.6                            | 81.6 | 61.8                                     | 72.6 | 56.4                             | 423   | 495                                     | 528       | 498  | 342       | 243   | 243   | 232       | 241   | 325   |  |